



## Ice Levelling system

The Ice Levelling system works by shaking the EPS box gently, at adjustable frequency and without stopping the transport line.



## ICE LEVELLING SYSTEM

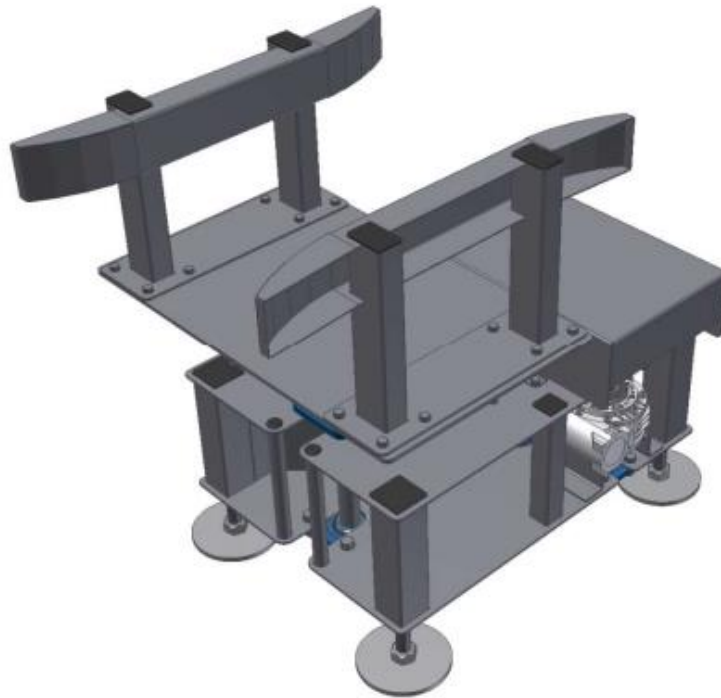

The MMC FIRST PROCESS Ice Levelling system is designed to gently level out the ice in EPS boxes containing fish. The machine shakes the box sideways, at the front and at the rear alternately. The effect is to flatten out the top surface of ice and fish in the box.

The machine can be inserted into an existing box conveyor with a minimum of rebuilding. Installing one of these machines reduces manual work and simplifies the process of applying lids, strapping and palletizing boxes.

It is important to avoid humps in the ice and achieve an even top surface. Having the correct level below the rim and inside the box facilitates a continuous fish handling process. There is less risk of pressure damage to the fish, the raw material is packed more smoothly and quality is improved.

The machine is designed so that the sideways movement is adjustable in extent, speed and position.

### PROPERTIES

- Compact design.
- Flexible adjustment of machine functions.
- Easy to instal in existing packing lines.

### ADVANTAGES

- Continuous flow in packing line.
- No ice will protrude above the box, so lid application is easier and more consistent.
- The palletizing process runs more smoothly and safely with properly fitted lids.

### VALUE

- Less damage to the fish, due to pressure from the ice (when the lid is strapped on).
- Easier lid application.
- Less ice on the box edge will lead to tidier strapping and palletizing